

Projects that **inspire**,  
**services** that deliver

At Consort, we make **impressions** that last



**CONSORT BUILDERS PVT. LTD.**

CONSTRUCTION & INTERIORS

AN ISO 9001:2008 CERTIFIED COMPANY

## Contents

1.	FINANCIALS.....	4
2.	ACCOLADES AND CERTIFICATIONS.....	5
3.	WHO WE ARE.....	7
4.	WHAT WE VALUE.....	7
5.	WHAT WE DELIVER.....	8
6.	TAILORED SERVICES FOR DIVERSE REQUIREMENTS .....	8
7.	SAFETY FIRST. ALWAYS.....	10
8.	SUBCONTRACTOR ENGAGEMENT & PROCUREMENT.....	10
9.	OUR CLIENTELE.....	11
10.	KEY MILESTONES THAT SHAPED OUR JOURNEY .....	12
11.	FLAGSHIP PROJECTS: DELIVERED AND UNDERWAY .....	17
12.	LIST OF OWNED PLANT AND EQUIPMENT/MACHINERY.....	25
13.	GALLERY OF FEW SELECTED PROJECTS.....	28
14.	PARTNERING TOWARD A BETTER TOMORROW .....	62

*“At Consort, we don’t just build structures - we build trust. Our commitment to delivering projects before time is not just a promise, it’s our practice.”*

- ➔ **25+ years' experience**
- ➔ **75+ Large Projects**
- ➔ **100+ satisfied clients**
- ➔ **Across 6 states & UT**
- ➔ **16 running projects covering over 1,24,46,000 ft<sup>2</sup> area**

Proud to have delivered  
over **3,21,20,250 ft<sup>2</sup>** of  
diverse projects

- ➔ **On-Time Delivery**
- ➔ **Inspired Architecture**
- ➔ **Client-Centric Approach**
- ➔ **Sustainable Construction**

➔ **Expert Team of Engineers and Professionals**

With a talent pool of over 750 highly qualified engineers and specialists, Consort brings together diverse expertise across every discipline of construction and development. Each member is a leader in their domain, contributing to our reputation for excellence.

➔ **A Workforce of 5,000+ Strong**

Our strength lies in our people. With a dedicated workforce of more than 5,000, we are equipped to handle multiple large-scale projects simultaneously, delivering with precision and speed.

## 1. FINANCIALS

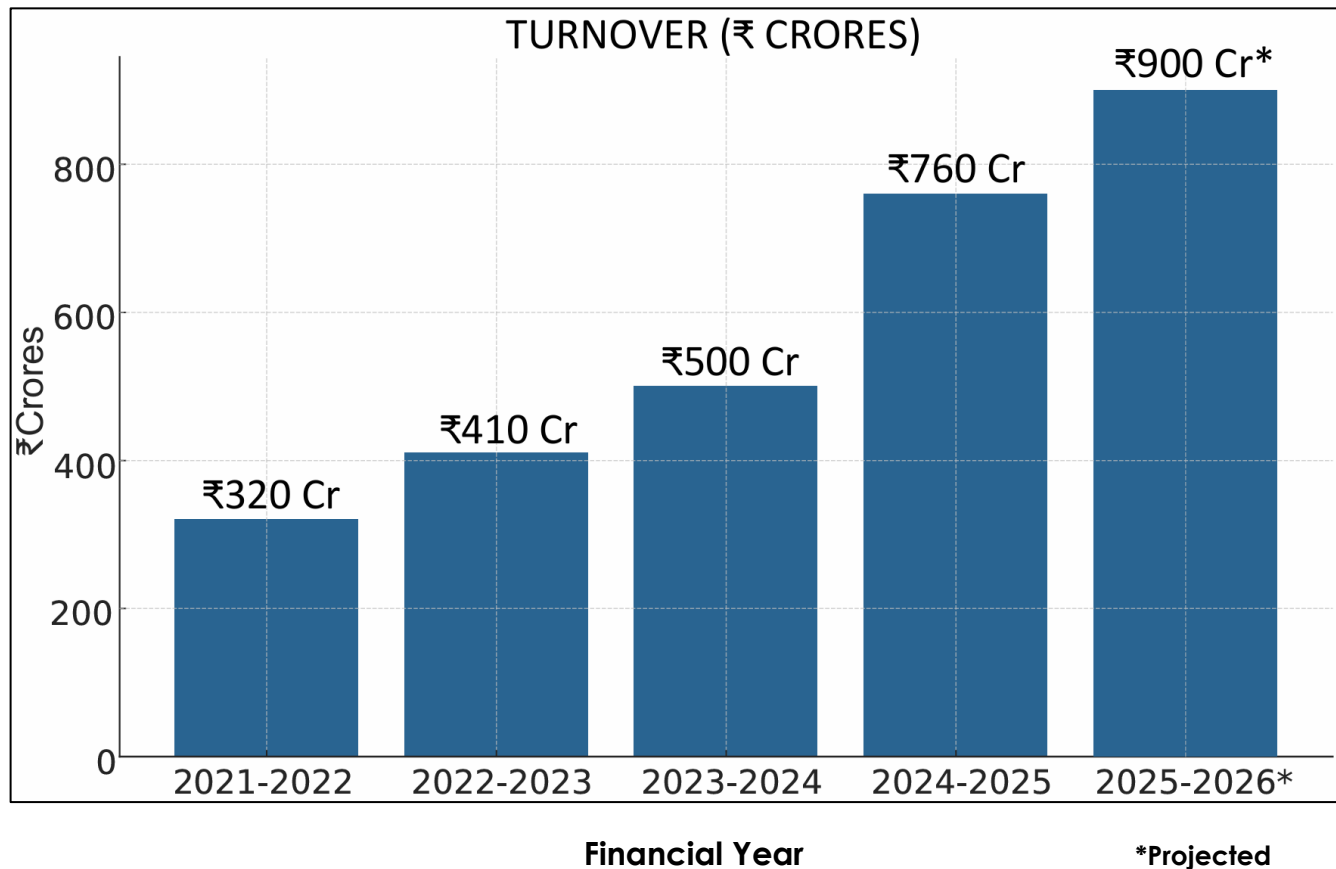

### Driving Growth. Building Trust

- ✓ Consort Builders has demonstrated remarkable financial growth, with **turnover rising from ₹320 Crores in FY 2021-22 to projected ₹900 Crores** for FY 2025-26. This consistent year-on-year expansion reflects our **strong market presence, operational excellence, and unwavering client trust**.
- ✓ With revenues more than **2.8 times in five years**, Consort Builders has **cemented its position as a dynamic and trusted player** in India's real estate and infrastructure sector.
- ✓ Our year-on-year revenue growth showcases not just numbers, but **the trust we've built and the scale of impact we deliver** across projects.



## 2. ACCOLADES AND CERTIFICATIONS

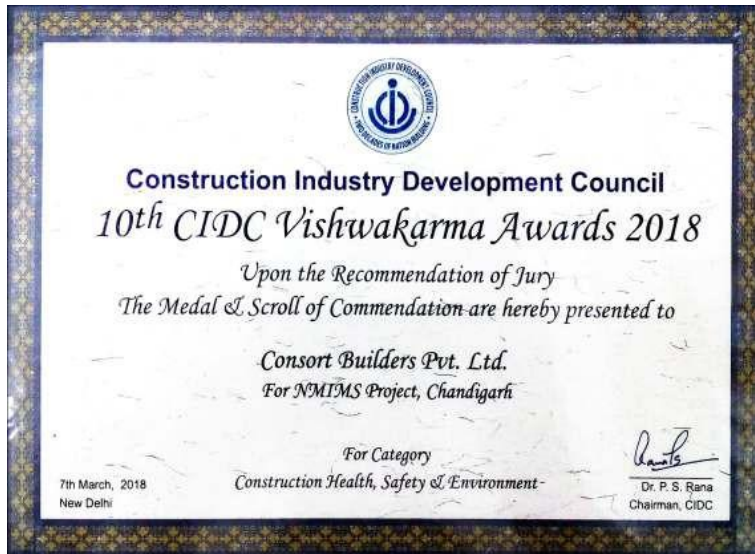

CIDC Vishwakarma Award  
For Construction HSE



Rashtriya Ispat Nigam Limited  
For highest lifting of steel bars  
Year 2024-25

**CPWD ENLISTMENT**

	भारत सरकार महानिदेशालय, के०लो०नि०वि०, सी० वि० एवं गु० संगठन संविदा एण्ड मैनुअल इकाई 335-ए, निर्माण भवन, नईदिल्ली-110011 टैलीफैक्स - 011-23061838 ईमेल - secm@nic.in	Govt. of India Directorate, CPWD CSQ, C&M Unit 335-A, Nirman Bhawan New Delhi-110011 Telefax - 23061838 Email - secm@nic.in
---	---	---

सं०: सी / 14- I(सुपर) / बिल्डिंग्स एंड रोड्स / 13 / 2022  
 No. C/14-I(Super)/Buildings & Roads/ 13/2022  
 e-file No. 9106739

दिनांक: 29.11.2022  
 Dated: 29.11.2022

सूचीबद्धता आदेश .....31..... { बिल्डिंग्स एंड रोड्स - I(सुपर) }  
 Enlistment Order -31 { Buildings & Roads -I(Super) }

निम्नलिखित आवेदक को उसके आवेदन के संदर्भ में महानिदेशक के०लो०नि०वि० द्वारा ठेकेदारी के लिए सूचीबद्ध किया जाता है।

With reference to his/her application, Director General CPWD is pleased to enlist the following applicant as contractor in CPWD.

Details of enlisted contractor	
1. Name of contractor	Consort Builders Private Limited
2. Status of entity	Company
3. Address	Regd. Off: House No 155, Housing Board Colony, Phase III, Baddi, District Solan (HP)-173205 Head Off: SCO 5, Chandigarh-Kalka Road, Opposite Peer Dargah, MDC Sector 5, Panchkula Haryana 134114
4. Category	Buildings & Roads
5. Class	I(Super)
6. Tendering limit	Rs. 650 (Six hundred Fifty) Crore
7. Enlistment valid upto	5 (Five) years from the date of issue of this order
8. Email	contact@consortbuilders.com
9. Mobile	9914254411
10. Landline number	01724000888
11. PAN No	AACCC4255E
12. GST registration number	06AACCC4255E1Z1

  
 N.R. MEENA  
 AEC-II

  
 K.R. MEENA  
 EE(Contract)

  
 VP Sahu  
 SE C&M

### 3. WHO WE ARE

#### **We Don't Just Build Structures — We Build Trust**

At Consort, trust is our foundation. For over 25 years, we've consistently delivered projects ahead of schedule, setting benchmarks in quality and client satisfaction.

#### **Two Decades of Transforming Landscapes**

Since inception, Consort Builders Pvt. Ltd. has shaped skylines and empowered communities across northern India, with a portfolio spanning residential, commercial, industrial, and hi-tech infrastructure.

#### **A Legacy of Excellence, A Vision for the Future**

With a strong footprint in Punjab, Haryana, Himachal Pradesh, Chandigarh, and Delhi-NCR, we are now expanding into new geographies and market segments — driven by sustainability and innovation.

#### **Collaboration & Innovation at Our Core**

Our culture of collaboration and deep technical expertise enables us to deliver complex, large-scale projects with precision, making Consort a trusted name for generations to come.

### 4. WHAT WE VALUE

#### **Integrity**

We uphold the highest ethical standards, fostering trust and accountability in every relationship - a reputation built on honesty.

#### **Quality**

Excellence is non-negotiable. Every project reflects our commitment to superior quality and lasting value.

#### **Safety**

People first. Our safety practices meet global benchmarks to protect our teams, partners, and communities.



## 5. WHAT WE DELIVER

At Consort, we see business as a long-term journey - guided by our vision and strengthened by lasting client partnerships. We deliver results that go beyond expectations.

As a fully integrated infrastructure company, we offer end-to-end solutions in construction, consultancy, and project management. Our projects combine expertise, innovation, and a sharp customer focus to achieve the highest standards.

Sustainability is at the core of our approach, ensuring every project creates positive, lasting impact for clients and communities.

## 6. TAILORED SERVICES FOR DIVERSE REQUIREMENTS

### 1. Scheduling

At Consort, we recognize that time is a critical asset. Our team applies precision and foresight to keep projects on track and resources optimized, minimizing delays and driving cost savings.

We tailor scheduling solutions for owners, contractors, and subcontractors across industries -whether developing schedules from scratch or streamlining existing plans.

#### ***Our Construction Scheduling Services Cover:***

- Critical Path Method (CPM) scheduling
- Program & preliminary schedules
- Resource- and cost-loaded schedules
- Schedule updates, delay analysis & time impact studies
- Risk simulations, "what if" scenarios & total float management
- Construction acceleration & as-built schedule analysis





## 2. Cost Estimating

At Consort, we provide precise cost estimating services from project conception to closeout - as standalone solutions or integrated into broader construction management.

By combining detailed quantity takeoffs with real-time and historical cost data, we deliver highly accurate estimates and validate costs at every stage. Our approach ensures financial goals are met while optimizing budgets and resources.

### Key Deliverables:

- Conceptual project budgets
- Construction bid estimates
- Contract cost reviews
- Lump sum & fixed price estimates
- Value engineering cost analysis
- Quantity take-offs & life cycle costing
- Change order evaluations & claims pricing
- Material escalation analysis & project closeout costs

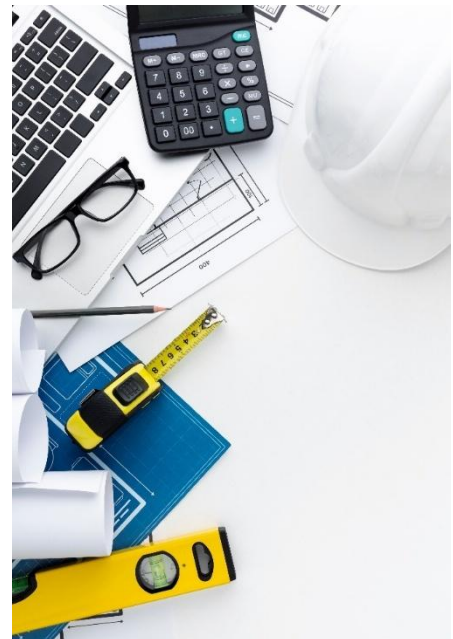

## 3. Value Engineering

At Consort, we help clients make informed decisions at every stage — from bid evaluation to cost validation - minimizing financial risks and ensuring project success.

Our methodical approach combines quantity take-offs, market-driven pricing, and productivity analysis to deliver estimates that are precise, realistic, and aligned with project goals. We also review submitted bids for errors or omissions, adding an extra layer of confidence before contracts are signed.



### Our Expertise Includes:

- Pre-construction planning & coordination
- Construction cost management & estimating
- Quantity take-offs & material escalation analysis
- Risk assessment & management techniques

Whether you're an owner, contractor, architect, or construction manager, our consultants provide the insights needed to optimize costs without compromising quality.

## 7. SAFETY FIRST. ALWAYS.

At Consort, safety isn't just a priority — it's a core value. We foster a culture where risks are proactively identified, assessed, and mitigated through training and action. Our people are our greatest asset, and their well-being shapes every decision we make.

Our comprehensive Safety Training System equips teams with the knowledge and tools to maintain safe, efficient work environments for both employees and the public.

### Our Safety Training Covers:

- Crane, rigging & aerial lift operations
- Fall protection & confined space safety
- Respiratory protection & PPE use
- Electrical safety & lockout/tagout procedures
- Fire, welding, cutting & spill containment safety
- Ladder, hand/power tool & excavation safety
- Lead, silica & hazard communication programs



## 8. SUBCONTRACTOR ENGAGEMENT & PROCUREMENT

At Consort, we know a project's success depends on the strength of its team — and our subcontractors are integral to that success. From the outset, we align them with project drawings, specifications, codes, and milestones to ensure seamless execution.

Our approach goes beyond delivery. We embed sustainability, environmental stewardship, and corporate responsibility into how we work with subcontractors and suppliers. By fostering long-term partnerships with those who share our commitment to excellence, we drive exceptional outcomes and a culture of shared success.



## 9. OUR CLIENTELE

When vision meets expertise, possibilities become realities. At Consort, we take pride in partnering with some of the most respected names across industries — building relationships founded on trust, collaboration, and excellence.



L'ORÉAL





## 10. KEY MILESTONES THAT SHAPED OUR JOURNEY

<p><b>Client:</b> CU International Educational Trust</p> <p><b>Project:</b> Campus</p> <p><b>Type:</b> Institutional</p> <p><b>Area:</b> 29,44,000 ft<sup>2</sup></p> <p><b>Location:</b> Lucknow, Uttar Pradesh</p> <p><b>Date of Completion:</b> Ongoing</p>	
 <p>Pharmacy A Block CGC Jhanjeri</p>	<p><b>21 Repeat Projects</b></p> <p><b>Client:</b> Chandigarh University (CGC+CU)</p> <p><b>Project:</b> Campus</p> <p><b>Type:</b> Institutional</p> <p><b>Area:</b> 84,56,782 ft<sup>2</sup></p> <p><b>Location:</b> Mohali, Punjab, 21 Locations</p> <p><b>Date of Completion:</b> Delivered 19 projects from Dec '2006 till Nov '2024 <b>ON TIME;</b> 2 projects ongoing</p>
<p><b>2 REPEAT PROJECTS</b></p> <p><b>Client:</b> Hero Realty Pvt. Limited</p> <p><b>Project:</b> Group Housing</p> <p><b>Type:</b> Residential</p> <p><b>Area:</b> 29,64,116 ft<sup>2</sup></p> <p><b>Location:</b> Mohali, Ph-II &amp; Ph-III, Punjab</p> <p><b>Date of Completion:</b> Ongoing</p>	

### 3 REPEAT PROJECTS

**Client:** Godrej Properties Ltd.  
**Project:** Group Housing  
**Type:** Residential  
**Area:** 21,96,138 ft<sup>2</sup>  
**Location:** Noida & Gurgaon (Delhi-NCR)  
**Date of Completion:** Delivered 2 projects  
 June 2019 and August 2024 ON TIME;  
 1 project ongoing



### 13 REPEAT PROJECTS

**Client:** Thapar Institute of Engineering and Technology  
**Project:** Campus  
**Type:** Institutional  
**Area:** 24,16,410 ft<sup>2</sup>  
**Location:** Patiala, Punjab, Various buildings  
**Date of Completion:** Delivered 12 projects  
 from Sep'2018 till Mar'2025 ON TIME;  
 1 project ongoing

**Client:** Elite Medicity  
**Project:** Hospital Building  
**Type:** Hospital  
**Area:** 6,00,000 ft<sup>2</sup>  
**Location:** Mohali, Punjab  
**Date of Completion:** Ongoing







**Client:** Govt. of HP Directorate of Industries

**Project:** Unity Mall

**Type:** Commercial

**Area:** 4,96,358 ft<sup>2</sup>

**Location:** Dharamshala, H.P.

**Date of Completion:** Ongoing

**Client:** Ishanvi Industrial & Logistics Park

**Project:** Ware Houses Including Development work

**Type:** Industrial

**Area:** 14,00,000 ft<sup>2</sup>

**Location:** Rajpura, Punjab

**Date of Completion:** December 2024



**Client:** IIT, Roorkee



**Project:** Hostel Building & Academic Block

**Type:** Institutional

**Area:** 4,52,104 ft<sup>2</sup>

**Location:** Roorkee, Uttarakhand

**Date of Completion:** August 2023

<p><b>Client:</b> HLP Galleria</p> <p><b>Project:</b> Spaces</p> <p><b>Type:</b> Commercial</p> <p><b>Area:</b> 8,50,000 ft<sup>2</sup></p> <p><b>Location:</b> Mohali, Punjab</p> <p><b>Date of Completion:</b> October 2023</p>	
	<p><b>Client:</b> Narsee Monjee Institute of Management Studies.</p> <p><b>Project:</b> Campus</p> <p><b>Type:</b> Institutional</p> <p><b>Area:</b> 12,00,000 ft<sup>2</sup></p> <p><b>Location:</b> Chandigarh</p> <p><b>Date of Completion:</b> October 2019</p>
<p><b>Client:</b> L'Oreal India Pvt. Ltd.</p> <p><b>Project:</b> Hair Color Plant</p> <p><b>Type:</b> Industrial</p> <p><b>Area:</b> 1,20,000 ft<sup>2</sup></p> <p><b>Location:</b> Baddi, Himachal Pradesh</p> <p><b>Date of Completion:</b> August 2016</p>	



<p><b>Client:</b> Sanathan Polycot Pvt. Limited</p> <p><b>Project:</b> Factory building</p> <p><b>Type:</b> Industrial</p> <p><b>Area:</b> 1,71,000 ft<sup>2</sup></p> <p><b>Location:</b> Wazirabad, Punjab</p> <p><b>Date of Completion:</b> Ongoing</p>	
	<p><b>Client:</b> Unitech Ltd.</p> <p><b>Project:</b> Group Housing</p> <p><b>Type:</b> Residential</p> <p><b>Area:</b> 10,02,084 ft<sup>2</sup></p> <p><b>Location:</b> Mohali and Noida, Delhi-NCR</p> <p><b>Date of Completion:</b> July &amp; Dec' 2014</p>
<p><b>Client:</b> Spray Engineering Devices Ltd.</p> <p><b>Project:</b> Corporate Office</p> <p><b>Type:</b> Office Building</p> <p><b>Area:</b> 8,50,000 ft<sup>2</sup></p> <p><b>Location:</b> Mohali, Punjab</p> <p><b>Date of Completion:</b> October 2008</p>	

## 11. FLAGSHIP PROJECTS: DELIVERED AND UNDERWAY

### 1. Institutional

S. No.	Owner or Sponsoring Organization	Name of Work/Project	Project Location	Status	Scope of Work	Area (Sq. Ft.)
1	CU International Educational Trust	Construction of civil structure, finishing work, MEP, internal /external electrical, lift, FF & STP complete in all respect	Lucknow, U.P.	Ongoing	Structure & Finishing	29,44,000
2	Chandigarh University	New boys hostel blocks	Mohali, Punjab	Completed	Structure & Finishing	15,56,662
3	Chandigarh University	Boys hostel	Mohali, Punjab	Completed	Structure & Finishing	12,60,000
4	Narsee Monjee Institute of Management Studies.	NMIMS campus at Chandigarh	Chandigarh	Completed	Structure work	12,00,000
5	Chandigarh University	Academic blocks & hostels blocks	Mohali, Punjab	Completed	Structure & Finishing	8,60,000
6	Chandigarh University	New hostel blocks NC campus, Gharuan	Mohali, Punjab	Completed	Structure & Finishing	6,20,000
7	Chandigarh Educational Society (Regd.), Jhaneri	Construction of civil structure, finishing work, MEP, internal electrical, Fire fighting and fire alarm complete in all respects of academic blocks (1 no.) and hostel blocks (3 no.).	Mohali, Punjab	Ongoing	Structure & Finishing	5,32,904
8	Chandigarh University	New administration block & girls hostel	Mohali, Punjab	Completed	Structure & Finishing	4,90,000
9	Chandigarh University	Polytechnic block & academic block	Mohali, Punjab	Completed	Structure & Finishing	4,87,000

S. No.	Owner or Sponsoring Organization	Name of Work/Project	Project Location	Status	Scope of Work	Area (Sq. Ft.)
10	IIT Roorkee	Construction of civil, structural and finishing works for hostel building & academic block.	Roorkee, Uttrakhand	Completed	Civil, Structural and Finishing works	4,52,104
11	TIET Patiala	Construction of hostel M & PG-1 at Thapar University	Patiala, Punjab	Ongoing	Civil Structure & Finishing Work	4,17,679
12	Chandigarh University	Administrative block	Mohali, Punjab	Completed	Structure & Finishing	4,02,000
13	Chandigarh University	South campus	Mohali, Punjab	Completed	Structure & Finishing	3,92,000
14	Chandigarh University	Academic block	Mohali, Punjab	Completed	Structure & Finishing	2,87,000
15	Chandigarh University	Construction of structure & finishing work of NC-11 new hostel block at CU	Mohali, Punjab	Ongoing	Civil Structure & Finishing Work	2,68,418
16	Chandigarh University	Polytechnic block	Mohali, Punjab	Completed	Structure & Finishing	2,35,000
17	TIET Patiala	Thapar University boys hostel	Patiala, Punjab	Completed	Civil Structure & Finishing	2,20,135
18	Thapar Institute of Engineering & Technology	Thapar University boys hostel	Patiala, Punjab	Completed	Civil Structure & Finishing Work	2,20,135
19	Thapar Institute of Engineering & Technology	Construction of civil, structural and MEP works for construction of new boys hostel. It is a G+8 hostel building.	Patiala, Punjab	Completed	Civil, structural and MEP Works	2,20,135
20	TIET Patiala	Thapar University girls hostel	Patiala, Punjab	Completed		2,20,135
21	Thapar Institute of Engineering & Technology	Civil, structural and MEP works for construction of new girls hostel (for 928 students)	Patiala, Punjab	Completed	Structure & Finishing	2,20,135



S. No.	Owner or Sponsoring Organization	Name of Work/Project	Project Location	Status	Scope of Work	Area (Sq. Ft.)
22	Thapar Institute of Engineering & Technology	Civil and MEP works for hostel 'Q'	Patiala, Punjab	Completed	It is a G+9 Hostel Building.	2,20,135
23	Thapar Institute of Engineering & Technology	Construction of hostel A at Thapar University	Patiala, Punjab	Completed	Structure & Finishing	2,20,135
24	Thapar Institute of Engineering & Technology	Civil and MEP works for Hostel 'D'	Patiala, Punjab	Completed	Civil and MEP Works	2,20,135
25	Chd Group of College, Landran	MBA II building	Mohali, Punjab	Completed	Structure & Finishing	1,80,000
26	Chd Group of College, Jhanjeri	Boys hostel	Mohali, Punjab	Completed	Structure & Finishing	1,70,116
27	Chandigarh University	Academic block-16, staff quarters & Sukhna hostel	Mohali, Punjab	Completed	Structure & Finishing	1,42,792
28	Chandigarh University	Girls hostel	Mohali, Punjab	Completed	Structure & Finishing	1,40,000
29	Thapar Institute of Engineering & Technology	Construction of civil, structural and MEP works for construction of faculty housing (FRD & FRE) It is a G+8 residential building.	Patiala, Punjab	Completed	Civil, structural and MEP Works	1,32,651
30	Chd Group of College, Landran	B-Tech 3 building	Mohali, Punjab	Completed	Structure & Finishing	1,15,000
31	Chandigarh University	Girls hostel & MCA block	Mohali, Punjab	Completed	Civil Structure & Finishing	1,07,000
32	Chandigarh Educational Society (Regd), Jhanjeri	Construction of academic building (pharmacy block) at CGC Tech. Campus, Jhanjeri, Mohali	Mohali, Punjab	Completed	Structure & Finishing	1,05,000

S. No.	Owner or Sponsoring Organization	Name of Work/Project	Project Location	Status	Scope of Work	Area (Sq. Ft.)
33	Thapar Institute of Engineering & Technology	Civil and MEP Works for Hostel 'B'	Patiala, Punjab	Completed	Structure & Finishing	90,000
34	Bharti Foundation	Sr. Sec. School Jhaneri & Rauni	Mohali, Punjab	Completed	Structural and Finishing works	88,625
35	Chandigarh Group of Colleges	Construction of management block	Mohali, Punjab	Completed	Structure & Finishing	80,000
36	Chandigarh Educational Society (Regd)	NC campus underpass Gharuan	Mohali, Punjab	Completed	Structure & Finishing	25,890
37	Thapar Institute of Engineering & Technology	Civil and MEP works for hostel 'C'	Patiala, Punjab	Completed	Structure & Finishing	15,000
38	TIET Patiala	Thapar University, (hardscape work)	Patiala, Punjab	Completed	Hardscape work	--

## 2. Residential

S. No.	Owner or Sponsoring Organization	Name of Work/Project	Project Location	Status	Scope of Work	Area (Sq. Ft.)
1	Hero Realty Private Limited	Construction of civil structure, finishing work, MEP, internal /external electrical, lift, FF & STP complete in all respect civil and finishing works	Mohali, Punjab	Ongoing	Structure & Finishing	22,00,000
2	Godrej Properties Ltd.	Godrej Nest	Noida, Delhi-NCR	Completed		11,23,066
3	Wave Estate	Construction of civil & structure work for Tower- I, J, K & L	Mohali, Punjab	Ongoing	Structure Work	9,00,000
4	Unitech Ltd.	Group Housing	Noida, Delhi-NCR	Completed	Civil Structure & Finishing	7,57,284
5	Ramprastha Promoters & Developers Pvt. Ltd.	Group Housing	Gurgaon, Delhi-NCR	Completed	Finishing Work	7,39,200
6	Godrej Properties Ltd.	Godrej Aravali, 101	Gurgaon, Delhi-NCR	Completed	Structural and finishing works	6,78,072
7	Wave Estate	MEP & finishing works	Mohali, Punjab	Completed	Finishing Work	5,72,750
8	Central Public Works Division (CPWD)	Group housing construction of separate family accommodation at SSB	Faridabad, Delhi-NCR	Ongoing	EPC Mode	5,44,545
9	Aerofront Developer	Highland Norwoods residential tower	Mohali, Punjab	Ongoing	Civil Structure & Finishing Work	5,41,000
10	Godrej Properties Ltd.	Group Housing (Godrej Nurture) Construction of structure, core and shell works of tower D1A and B3A & NTA	Noida, Delhi-NCR	Ongoing	Structure Work	3,95,000

S. No.	Owner or Sponsoring Organization	Name of Work/Project	Project Location	Status	Scope of Work	Area (Sq. Ft.)
11	Alice Developers Private Limited	Group Housing, Unihomes & Singleton	Mohali, Punjab	Completed	Civil Structure & Finishing	3,88,800
12	Unitech Ltd.	Group Housing	Mohali, Punjab	Completed	Civil Structure & Finishing	2,44,800
13	Alice Developers Pvt. Ltd. (Unitech Group)	Group Housing Complex	Mohali, Punjab	Completed	Structure & Finishing	2,44,800
14	Alice Developers Pvt. Ltd. (Unitech Group)	Uniworld City	Mohali, Punjab	Completed	Structure & Finishing	1,44,000
15	Semi-Conductor Laboratory (A unit of ISRO)	Construction of residential quarters for employees	Mohali, Punjab	Completed	Civil Structure & Finishing	55,638

### 3. Industrial

S. No.	Owner or sponsoring Organization	Name of Work/Project	Project Location	Status	Scope of Work	Area (Sq. Ft.)
1	Ishanvi Industrial & Logistics Park Private Limited, Mumbai	Construction of structure, finishing & external develop. works of ware houses including development work	Rajpura, Punjab	Completed	Structure, Finishing & External Developmental Works	14,00,000
2	SML ISUZU Ltd.	Utility vehicle plant	Ropar, Punjab	Completed	Structure & Finishing	2,00,000
3	Cargill India Pvt. Ltd.	Feed mill	Bathinda, Punjab	Completed	Civil Structure & Finishing	1,72,000
4	Sanathan Polycot Private Limited, Mumbai	Construction of structure & finishing work of C.P & POY building & allied works	Wazirabad, Punjab	Ongoing	Structure & Finishing	1,71,000
5	L'Oreal India Pvt. Ltd.	Hair colour plant	Baddi, H.P.	Completed	Structure & Finishing	1,20,000
6	Glenmark Pharmaceuticals	Bulk drug plant	Aurangabad, Maharashtra	Completed	Civil Structure & Finishing	1,08,200
7	Centrient Pharmaceuticals,	Job contract for civil works-Taraang II	Nawanshahr, Punjab	Completed	Civil Structure & Finishing	75,000
8	TVS Motors	Expansion of 2-wheeler plant	Nalagarh, H.P.	Completed	Structural and Finishing works	70,000
9	Exicom Telesystem Ltd.	Electronic components	Gurgaon, Delhi-NCR	Completed	Structure & Finishing	65,000
10	Dr. Reddy's Laboratories Ltd.	OSD & injectable facility	Baddi, H.P.	Completed	Civil Structure & Finishing	40,000
11	Esys Information Technologies	Spinning mill	Nalagarh, H.P.	Completed	Civil Structure & Finishing	
12	General Cables Energy India	Office cum industrial building	Baddi, (H.P)	Completed	Civil Structure & Finishing	

#### 4. Office Building, Hospital and Commercial

S. No.	Owner or Sponsoring Organization	Name of Work/Project	Project Location	Status	Scope of Work	Area (Sq. Ft.)
1	RGI Infra	Construction of structure work at grand carnival, Aerocity	Mohali, Punjab	Ongoing	Civil Structure & Finishing Work	10,50,000
2	HLP Galleria, Mohali	Construction of civil structural works for commercial spaces 2B+G+4 floors.	Mohali, Punjab	Completed	Civil Structural works	8,50,000
3	M/s CEE DEE Developers	Cyber Square	Mohali, Punjab	Ongoing	Composite Civil Work	6,21,000
4	Elite Medicity	Civil structure works of Elite Medicity Hospital	Mohali, Punjab	Ongoing	Civil & Structure Work	6,00,000
5	Govt. of HP Directorate of Industries	Unity Mall	Dharamshala H.P.	Ongoing	Composite Civil Work	4,96,358
6	Spray Engineering Devices Ltd.	Administration building and corporate office	Mohali, Punjab	Completed	Civil Structure & Finishing	1,40,000
7	Damcosoft Pvt. Ltd.	IT building	Chandigarh	Completed	Civil Structure & Finishing	51,700
8	Himachal Futuristic Communications	Corporate office	Gurgaon, Delhi-NCR	Completed	Civil Structural and Finishing works	39,000
9	Vodafone Essar South Ltd.	Office building work and interior	Mohali, Punjab	Completed	Civil Structure & Finishing	-
10	HP Tourism Development Board	Beautification of Palampur and Nagrota Bagwan	Palampur & Nagrota (H.P.)	Ongoing	Composite Civil Work	-

## 12. LIST OF OWNED PLANT AND EQUIPMENT/MACHINERY

S. No.	Model and Power Rating	Quantity
1	Tower Crane MCI 85A/B	16 Nos.
2	Tower Crane SANY T6515-6	7 Nos.
3	Mobile Tower Crane	3 Nos.
4	Batching Plant 45 m	3 Nos.
5	Batching Plant CP30	8 Nos.
6	Transit Mixer	31 No.
7	Boom Placer	4 Nos.
8	Concrete Pump	20 Nos.
9	Backhoe Loader 3DX	11 No.
10	Wheel Loader 430 ZX	1 No.
11	Tandem Roller 10 Ton	1 No.
12	Tandem Roller 3.5 tons	3 Nos.
13	Tandem Roller 1.5 tons	1 No.
14	Soil Compactor 10 tons	1 No.
15	Tractor Trolley	12 Nos.
16	Weigh Bridge	9 Nos.
17	Material Hoist 1000 kg	19 Nos.
18	Mixture Machine Diesel	22 Nos.
19	Water Tanker 5000 liters	14 Nos.
20	Monkey Hoist, capacity 280 kg	35 Nos.
21	Diesel Generator	36 Nos.
22	Bar Cutting Machine	56 Nos.
23	Bar Bending Machine	51 No.



S. No.	Model and Power Rating	Quantity
24	Ring Making Machine	33 Nos.
25	Welding Set Double Phase 350 A	78 Nos.
26	Welding Set Double Phase 250 A	20 Nos.
27	Demolition Hammer 11 kg	61 No.
28	Electric Vibrator 3 HP Three Phase	134 Nos.
29	Earth Compactor	17 Nos.
30	Walk Behind Roller	1 No.
31	Digital Cube Testing Machine	14 Nos.
32	Manual Cube Testing Machine	3 Nos.
33	Cradle Capacity 800 kg	9 Nos.
34	Total Station Survey	17 Nos.
35	Auto Level Survey	30 Nos.
36	Dewatering Pump 5 HP Diesel	10 Nos.
37	Dewatering Pump 7.5 HP Electrical	14 Nos.
38	Dewatering Pump 15 HP Electrical	3 Nos.
39	Mono Block Pump 5/7.5/10 HP	66 Nos.
40	Container 20 Feet Lab	5 Nos.
41	Container 40 Feet Material	5 Nos.
42	Container 40 Feet Office	10 Nos.
43	Air Compressor Cps 325	1 No.
44	Anti-smog Gun, Capacity: 30 m	4 Nos.
45	Shuttering Plates	27300 m <sup>2</sup>
46	Cup Block System	2015 MT
47	Brick Cutting Machine	13 Nos.
48	Sand Screening Machine	3 Nos.

S. No.	Model and Power Rating	Quantity
49	Mobile Toilet	9 Nos.
50	Mahindra Bolero	3 Nos.
51	Tata 407	3 Nos.
52	Mahindra Camper	1 No.
53	Security Cabin	3 Nos.
54	Floor Cleaning Machine	3 Nos.
55	High Pressure Washer Pump	4 Nos.
56	Distribution Panel 63 Amp IP44/67	275 Nos.
57	Distribution Panel 250 Amp IP67	15 Nos.
58	Gas Cutting Set	15 Nos.
59	Horizontal Directional Drilling	10 Nos.
60	Blowing Machine with Compressor	4 Nos.

## 13. GALLERY OF FEW SELECTED PROJECTS

### Institutional – Star Building, Chandigarh University



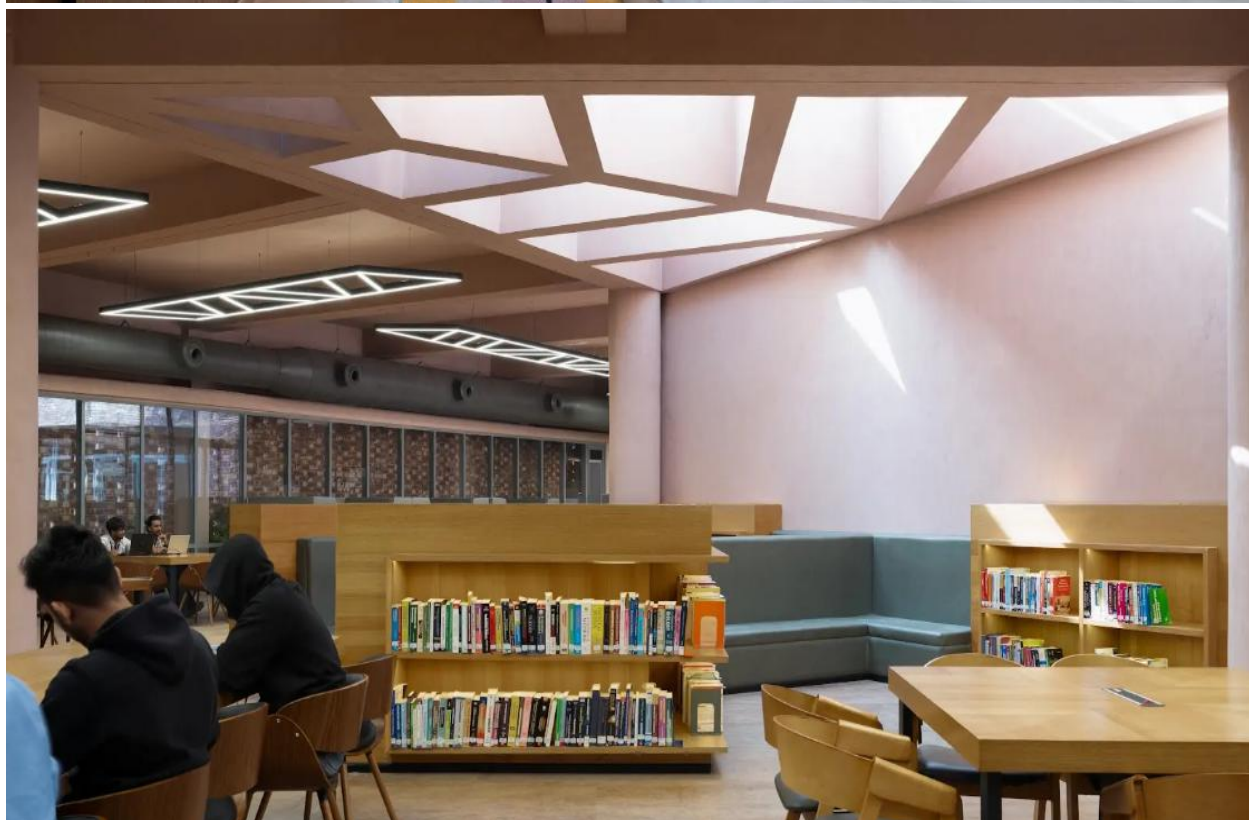



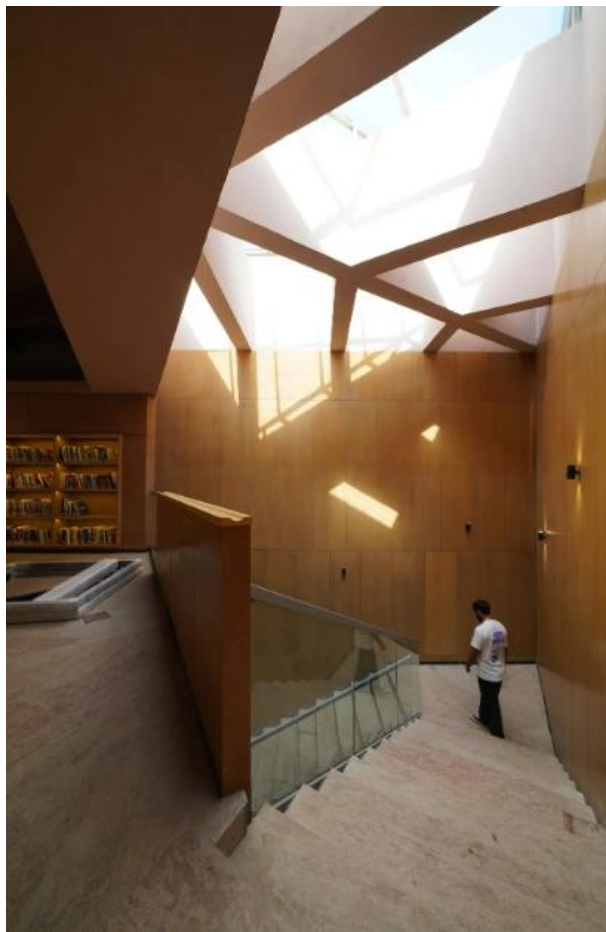



### Institutional – CGC, Jhanjeri

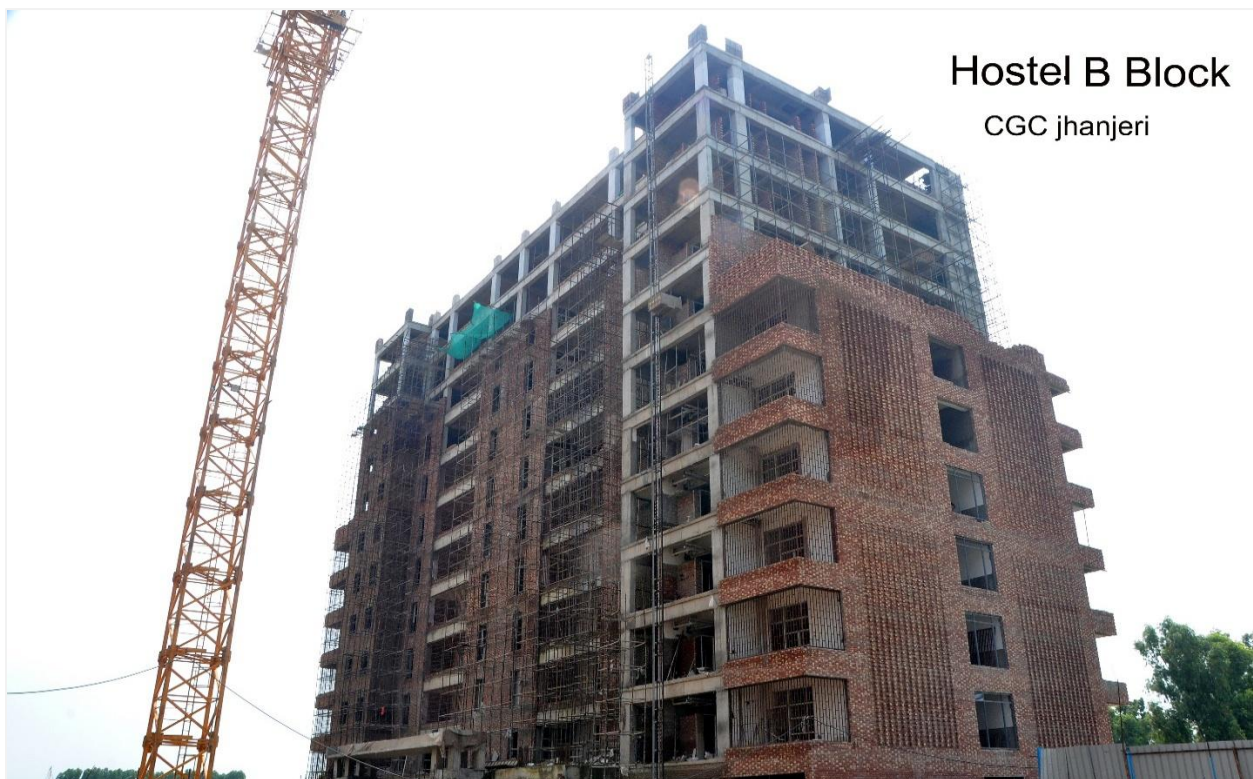



### Institutional – Chandigarh University, Lucknow





**Institutional – Thapar University, Patiala**





### Institutional – IIT Roorkee



**Institutional – Narsee Monjee Institute of Management Studies, Chandigarh**





### Institutional – Chandigarh University, Gharuan





**Commercial – Unity Mall, Dharamshala, H.P.**











### Residential – Semiconductor Laboratory, Mohali





### Residential – Ramprastha City, Gurgaon



**Residential – Uniworld City, Mohali (Unitech)**





### Residential – SSB at NIT, Faridabad





### Residential – Godrej Properties Ltd., Gurgaon





### Residential – Godrej Properties Ltd., Noida





### Residential – Hero Homes, Mohali





**Industrial – L'OREAL India, Baddi, H.P.**



**Industrial – Indospace Logistics Park, Rajpura, Punjab**





### Industrial – SML ISUZU, Ropar, Punjab





**Industrial – TVS Motor, Nalagarh, H.P.**



**Industrial – Glenmark (Baddi & Aurangabad)**





**Industrial – Cargill India Pvt. Limited, Bathinda, Punjab**



**Industrial – Centrient Pharmaceuticals, Ropar, Punjab**





**Industrial – SEDL, Baddi, H.P.**

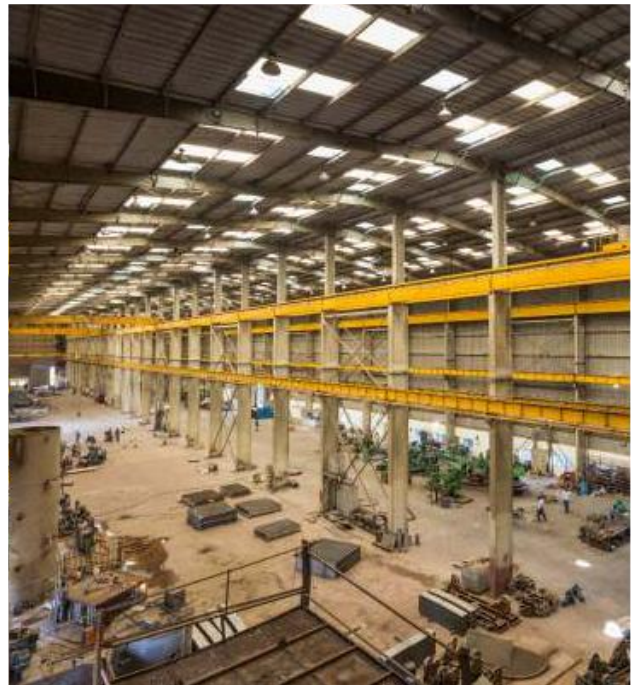

**Industrial – General Cables Ltd., Baddi, H.P.**





**Commercial – RGI Grand Carnival, Aerocity, Mohali, Punjab**





**Commercial – HLP Galleria, Mohali, Punjab**



**Commercial – Airtel, Mohali, Punjab**





**Commercial – DAMCOSOFT, IT Park, Chandigarh**



**Commercial – HFCL, Gurgaon, Haryana**





**Commercial – Spray Engineering Devices Limited, Mohali, Punjab**



---

## 14. PARTNERING TOWARD A BETTER TOMORROW

We appreciate your time and interest in Consort Builders Pvt. Ltd.

We look forward to the opportunity to collaborate and help bring your vision to life - with integrity, innovation, and precision.

For project inquiries or to connect with our team, feel free to reach out:

### **CONSORT BUILDERS PVT. LTD.**

SCO-7, Chandigarh- Kalka Road  
Opp. Peer Dargah  
Sector-5, MDC  
Panchkula – 134114  
Haryana, India

**Phone:** +91 172 4000888

**Email:** [contact@consortbuilders.com](mailto:contact@consortbuilders.com)

**Website:** [www.consorbuilders.com](http://www.consorbuilders.com)

*Let's build something lasting — together.*